



## High Load Sensor (HLS)

The High Load Sensor (HLS) is an electronic safety system designed to detect the height of a forklift's load to minimise this risk and in turn alert the forklift operator with a light/buzzer.

The HLS equipment is mounted on top of the forklift free of any interference.

The detection distance to the unacceptable load height is configurable.

The HIGH LOAD SENSOR safety system consists of:

1. HLS Device
2. HLS Sensor
3. HLS metallic support
4. Power cable
5. Red flashing waterproof light + buzzer



**Overload detection of the load**

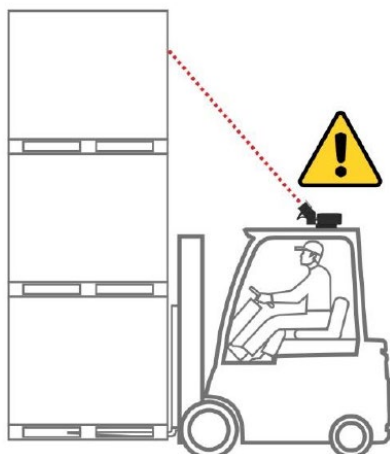

**No detection (correct loading height)**

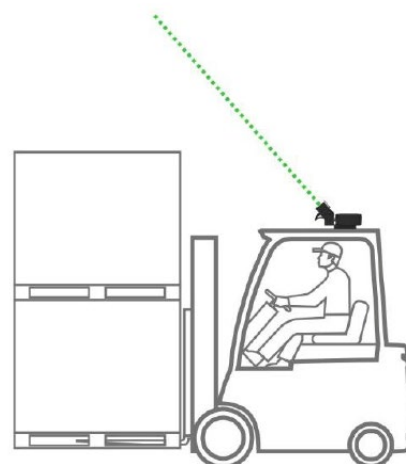



## Setup and adjustment of the HLS sensor

1. Mount the HLS steel support to the top of the forklift.

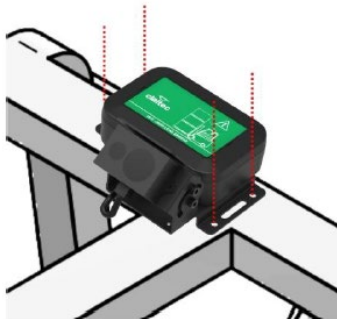

2. Tilt the HLS sensor to the desired maximum height. (if necessary, loosen screws A and B with an Allen key).

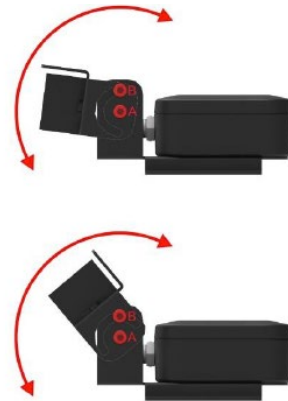

3. Fix the HLS sensor. Using an Allen key, tighten screws A and B.



4. Adjust detection distance.

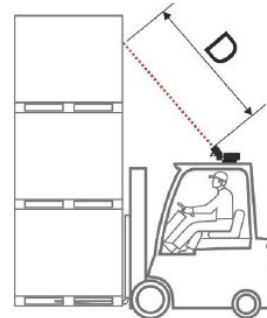

## Specifications

|                               |                    |
|-------------------------------|--------------------|
| Nominal voltage:              | +24 VDC ± 18-36VDC |
| Maximum voltage for 1 second: | +30 VDC            |
| Nominal consumption:          | 75 mA              |
| Peak consumption:             | 90 mA              |
| Adjustable distance:          | 0,5-12 metres      |

|                                  |                 |
|----------------------------------|-----------------|
| <b>Environmental conditions:</b> |                 |
| IP rating:                       | IP67            |
| Working temperature:             | -40 °C a +85 °C |
| Warehousing temperature:         | -40 °C a +85 °C |

### Digital Output:

|                        |          |
|------------------------|----------|
| Contact Relay 1 LOAD:  | N.O+N.C. |
| Contact Relay 2 LOAD:  | N.C.     |
| Contact Relay 1 ERROR: | N.C.     |

### Materials and dimensions:

|                 |                 |
|-----------------|-----------------|
| Dimensions:     | 200x110x60mm.   |
| Weight:         | 790 g           |
| Box's material: | ABS (UL 94 V-0) |