

SHOCKWATCH®

Damage Prevention and Safety Solutions

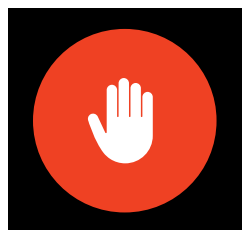

Visual Alert System (VAS)



[Click here for Product Video](#)



**Warning signs
that stop people
in their tracks.**



200W



120W



50W



Lens artwork examples

Shining the light on workplace safety.

The ShockWatch Visual Alert System (VAS) is an innovative device which warns pedestrians and/or forklifts in situations of risk by projecting signals on the ground. This system differs from other signage options in that its highly effective and visible.

Experience shows us that projections on the ground provide better visibility than those projected above. They are also better than the commonly used panoramic mirrors, since these are often placed too high to be seen and paid attention to. In many cases, these mirrors become part of the workplace landscape and operators don't give them due consideration.

The projector has 1 to 3 different colour lenses and the projected symbols are customisable. Some examples of what can be projected are forklifts, pedestrians, STOP signs, speed limits, 'no smoking' warnings or even that the use of mobile phones is prohibited, amongst many others.

There are five types of projectors available: 50W fixed and rotational, 120W rotational and 200W rotational in different projection ratios of 0.3 and 1.0.

The 50W projector is recommended for sites that have low ambient light, while the 120W and 200W are both more powerful units and suitable for warehouses or production plants with

brighter lighting.

The VAS is ideal for use in warehouses, logistics centres, production areas, spaces separating production areas from offices, corridors and transit areas in industrial spaces, as well as in blind spots in work spaces.

Also, this system can be combined with the ShockWatch Pedestrian Alert System (PAS), which warns drivers when a person is detected at distances of 1 to 6.5 metres.

To find out more about the Visual Alert System contact us at solutions@shockwatch.com.au

VAS Example 1: Blind Corner – Forklift Detection – PAS

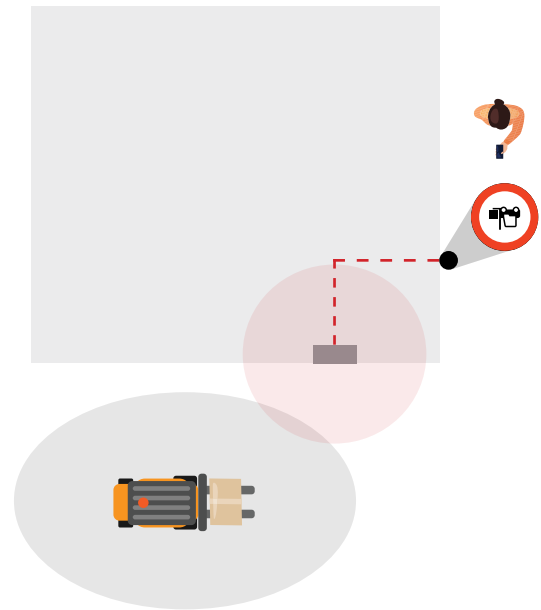
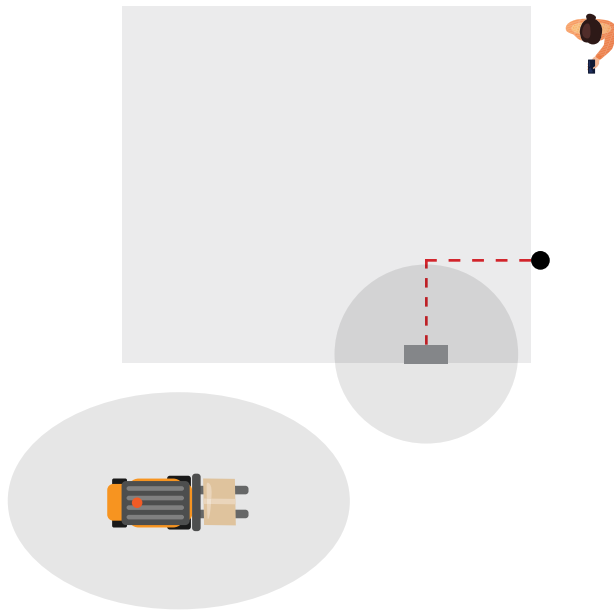

System Components:

- All forklifts are fitted with ShockWatch Pedestrian Alert System (PAS)
- A Tag is fitted to the wall

Main Operating Characteristics:

- When forklift is detected in range of wall Tag, it triggers the light and/or buzzer on blind side of intersection to alert oncoming traffic of approaching forklift or pedestrian
- Detection range up to 7m

VAS Example 2: Doorway – Pedestrian Detection – Beam

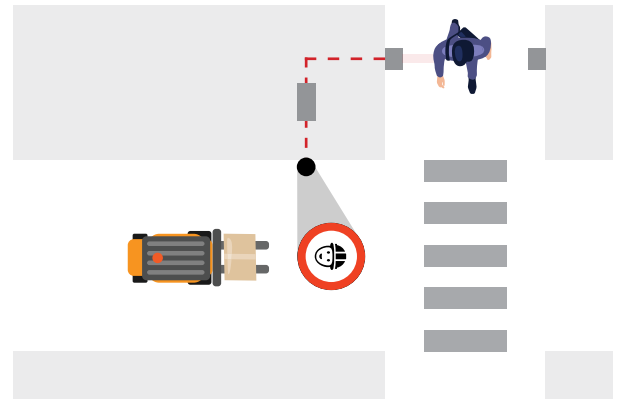
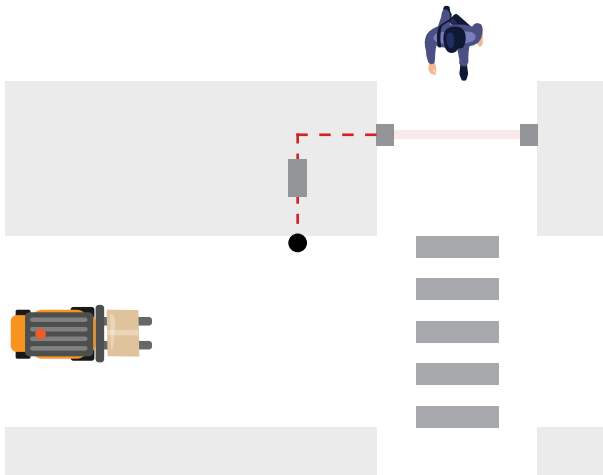

System Components:

- Reflector beam fitted near pedestrian crossing
- Reflector mirror fitted opposite reflector beam
- Control Unit connected to mains power

Main Operating Characteristics:

- When pedestrian approaches pedestrian crossing a beam is broken to trigger the light alert

For a tailored solution to your warehousing issue,
feel free to get in touch with us. solutions@shockwatch.com.au

Projector Technical Specifications

200W Models

1.0 (1m height = Ø 1.0m projection)

0.3 (1m height = Ø 0.3m projection)

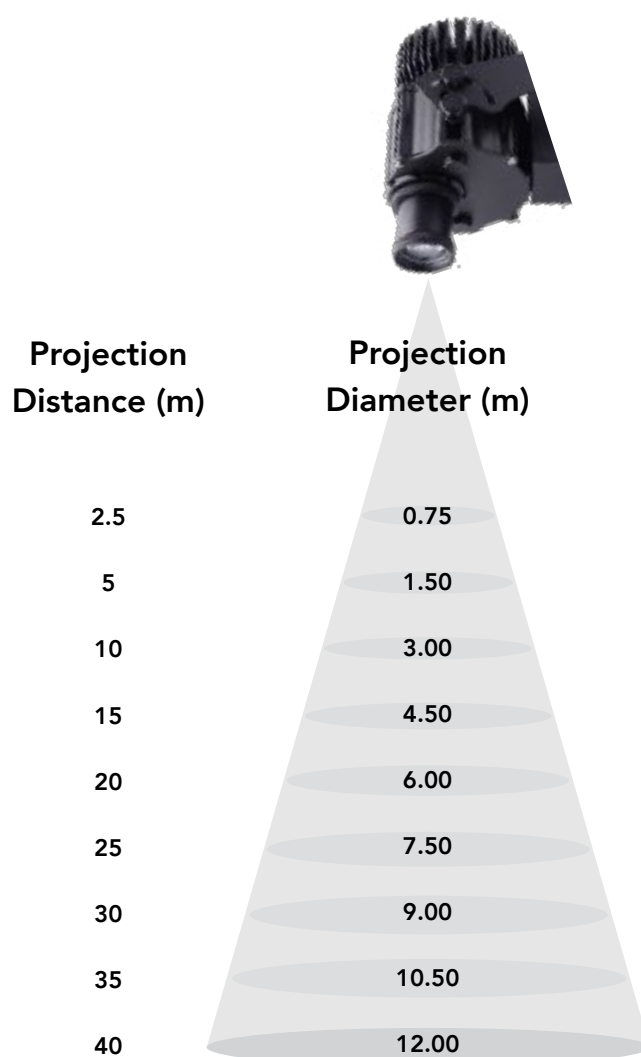
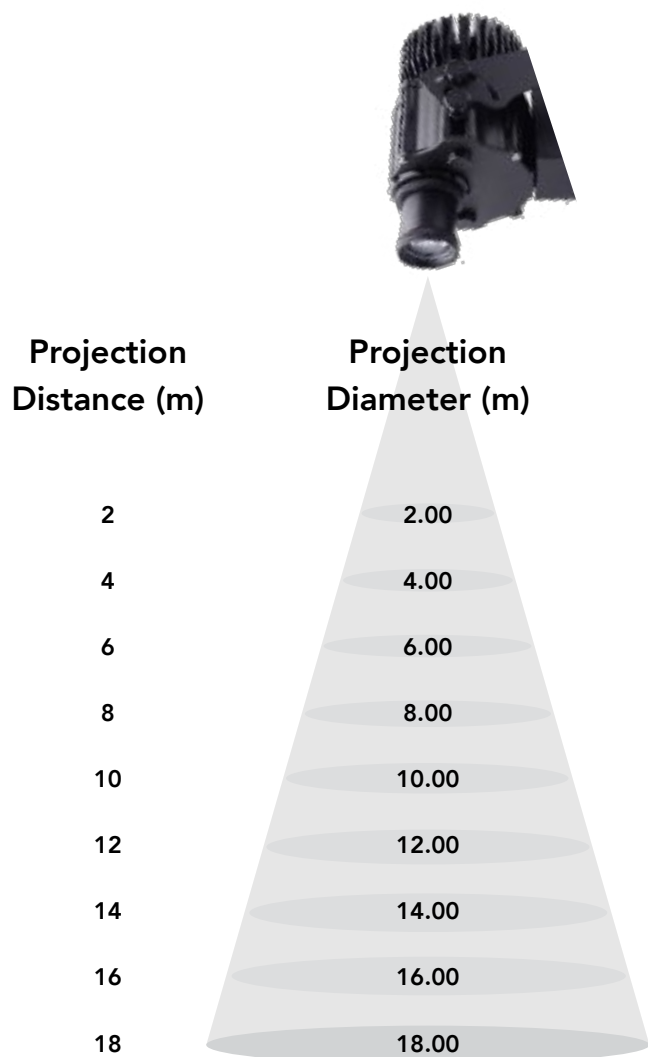

Light Whole Power (Watts)	200	200
Dimensions (LxWxH)	320mm x 175mm x 230mm	320mm x 175mm x 230mm
Material / Weight	Aluminium / 4.8kg	Aluminium / 4.8kg
Power	85-265V	85-265V
Frequency	50/60Hz	50/60Hz
Enclosure Protection Class	IP65	IP65
LED Source	Cree Xlamp CXA3050	Cree Xlamp CXA3050
LED Lifetime	30,000 hours	30,000 hours
Lumens	24,000	24,000
Projection Ratio	1.0 (1m height = Ø 1.0m projection)	0.3 (1m height = Ø 0.3m projection)
Image Rotation	Yes (button to stop rotation)	Yes (button to stop rotation)
Hours of Continuous Operation	24h	24h
Operating Temp	-20°C – 65°C	-20°C – 65°C

Projector Technical Specifications

120W Model

0.3 (1m height = Ø 0.3m projection)

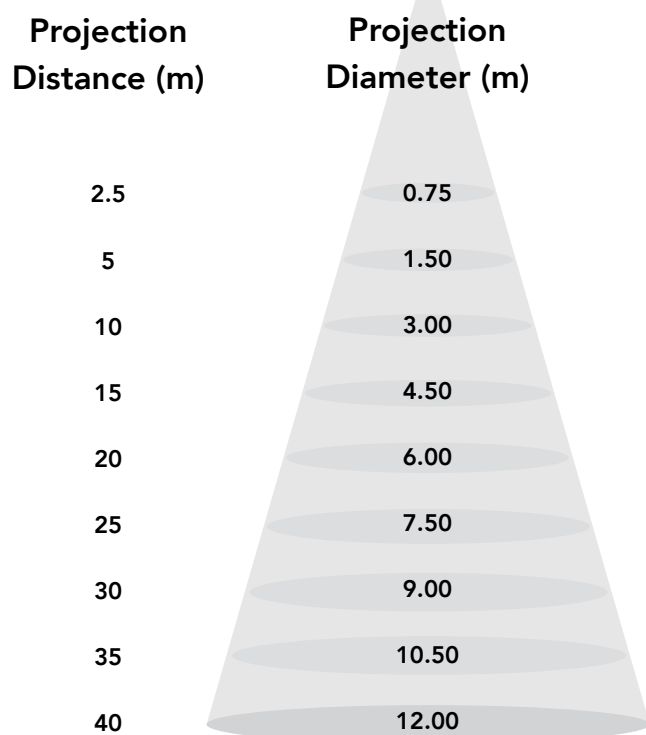

Light Whole Power (Watts)	120
Dimensions (LxWxH)	320mm x 175mm x 230mm
Material / Weight	Aluminium / 4.8kg
Power	85-265V
Frequency	50/60Hz
Enclosure Protection Class	IP65
LED Source	Cree Xlamp CXA3050
LED Lifetime	30,000 hours
Lumens	12,000
Projection Ratio	0.3 (1m height = Ø 0.3m projection)
Image Rotation	Yes (button to stop rotation)
Hours of Continuous Operation	24h
Operating Temp	-20°C – 65°C

Projector Technical Specifications

50W Models

0.3 (1m height = Ø 0.3m projection)

Fixed Lens



Projection
Distance (m)

Projection
Diameter (m)

1	0.75
2	1.50
3	3.00
4	4.50
5	6.00
6	7.50
7	9.00
8	10.50
10	12.00

0.3 (1m height = Ø 0.3m projection)

Rotating Lens



Projection
Distance (m)

Projection
Diameter (m)

1	0.75
2	1.50
3	3.00
4	4.50
5	6.00
6	7.50
7	9.00
8	10.50
10	12.00

Light whole Power (Watts)	50	50
Dimensions (LxWxH)	280mm x 80mm x 180mm	220mm x 150mm x 210mm
Material / Weight	Aluminium / 2kg	Aluminium / 2kg
Power	85-265V	85-265V
Frequency	50/60Hz	50/60Hz
Enclosure Protection Class	IP65	IP65
LED Source	Cree Xlamp XHP70	Cree Xlamp XHP70
LED Lifetime	30,000 hours	30,000 hours
Lumens	3,500	3,500
Projection Ratio	0.3 (1m height = Ø 0.3m projection)	0.3 (1m height = Ø 0.3m projection)
Image Rotation	No	Yes (button to stop rotation)
Hours of Continuous Operation	No longer than 12 hours of continuous use	24h
Operating Temp	-20°C – 65°C	-20°C – 65°C

The ShockWatch range of Accident Prevention Solutions.

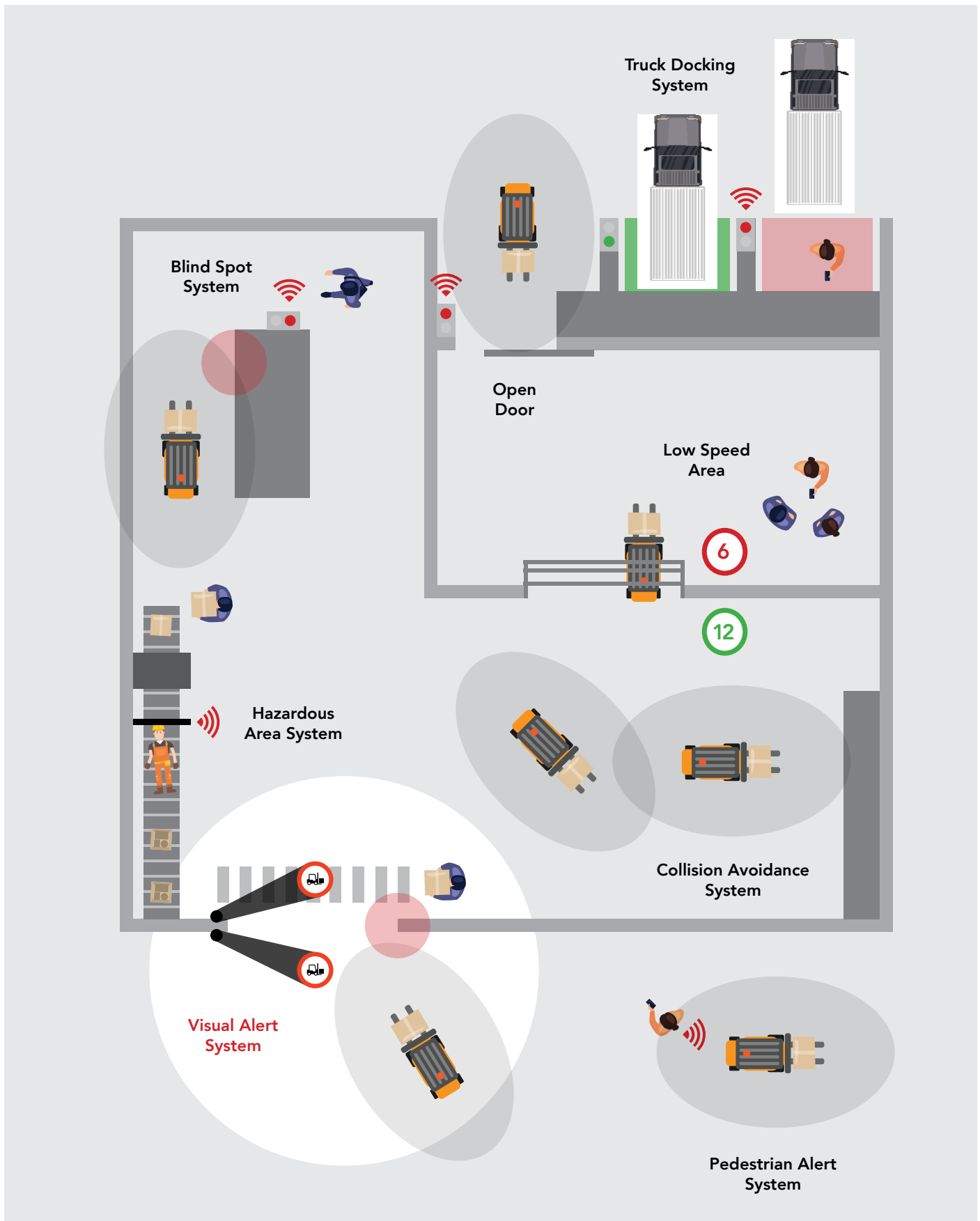

Our Clientele.

SHOCKWATCH®
Damage Prevention and Safety Solutions

Australia



Worldwide



SHOCKWATCH®

Damage Prevention and Safety Solutions

1300 074 625

solutions@shockwatch.com.au

shockwatch.com.au

Mar 2022

